

Model: IGRINC-001

BRUSHLESS ANGLE GRINDER

Adendorff
machinery mart

Kinway

OPERATING INSTRUCTIONS / USER MANUAL

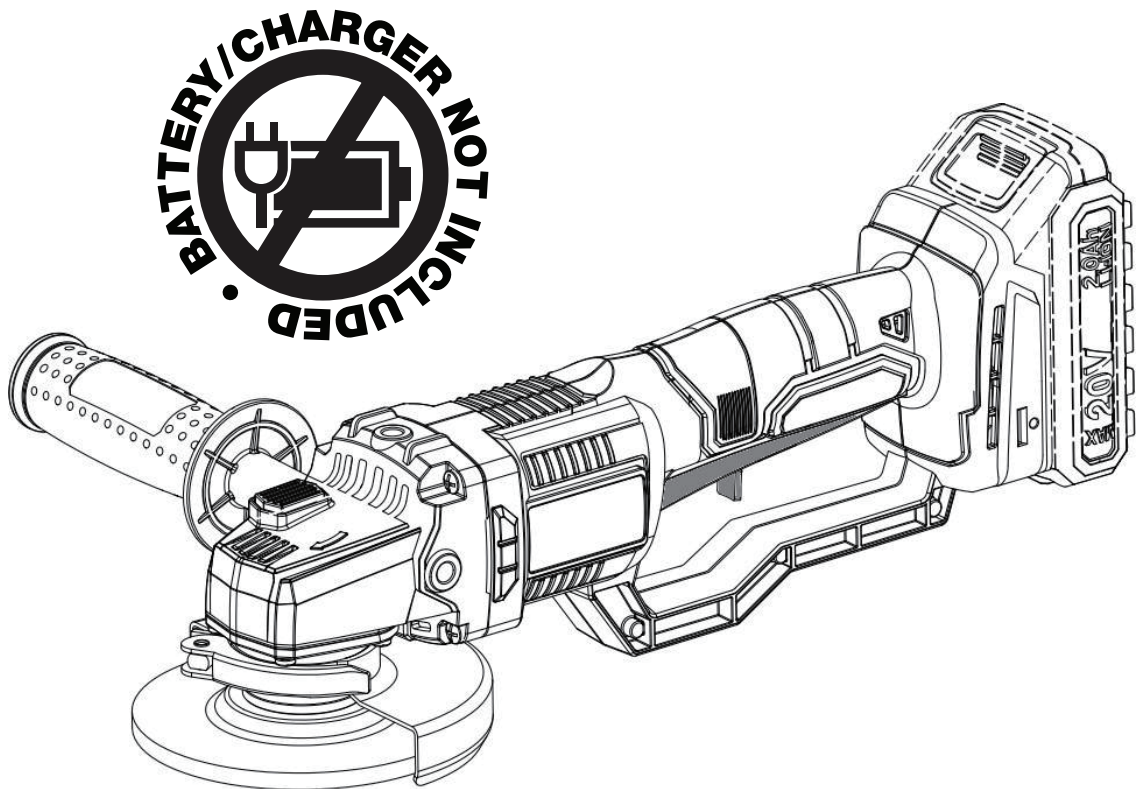

DANGER! Read all safety regulations and instructions. Keep all safety regulations and instructions in a safe place for future use.



2025

E&OE Please Note that details and specifications contained herein, are correct at the time of publishing. Adendorff reserve the right to change specifications at any time without prior notification.

IMPORTANT SAFETY INFORMATION

Thank you for purchasing this quality product. We want to help you get the best results from your new equipment and to operate it safely.

This manual contains the information on how to do that; please read it carefully. You will need this manual for the safety warnings and precautions, operating, maintenance and cleaning procedures, parts list and assembly diagram. Keep your invoice with this manual. Write the invoice number on the inside of the front cover. Keep this manual and invoice in a safe and dry place for future reference.

This manual should be considered a permanent part of the product and should remain with it if it is resold.

SAFETY PRECAUTIONS

Your safety and the safety of those around you are of utmost importance. This manual includes essential safety messages—please read them carefully to ensure proper use and avoid potential hazards.

The failure to follow instructions may result in damage to your power tool, other property, or the environment.

Product Information & Disclaimer

All details and specifications provided in this publication are based on the latest available product information at the time of printing.

We reserve the right to make updates at any time without prior notice or obligation.

Reproduction of any part of this manual is prohibited without written permission.

By following these safety guidelines, you can ensure the proper use of your equipment while protecting yourself, others, and your surroundings.

TECHNICAL SPECIFICATIONS

MODEL	IGRINC-001
DISC DIAMETER:	115mm
BATTERY VOLTAGE:	DC 20V
BATTERY TYPE:	Lithium-Ion
NO-LOAD RPM:	7000 RPM
WEIGHT:	1.08kg
INCLUDES:	1 Side Handle
	1 Protective Guard
	1 Spanner

Please note that the accessories shown in this manual may either be included with the unit upon purchase or may not be available for sale or included at all. Additionally, certain key features depicted may not be standard. This manual is intended for reference purposes only.

PART LIST

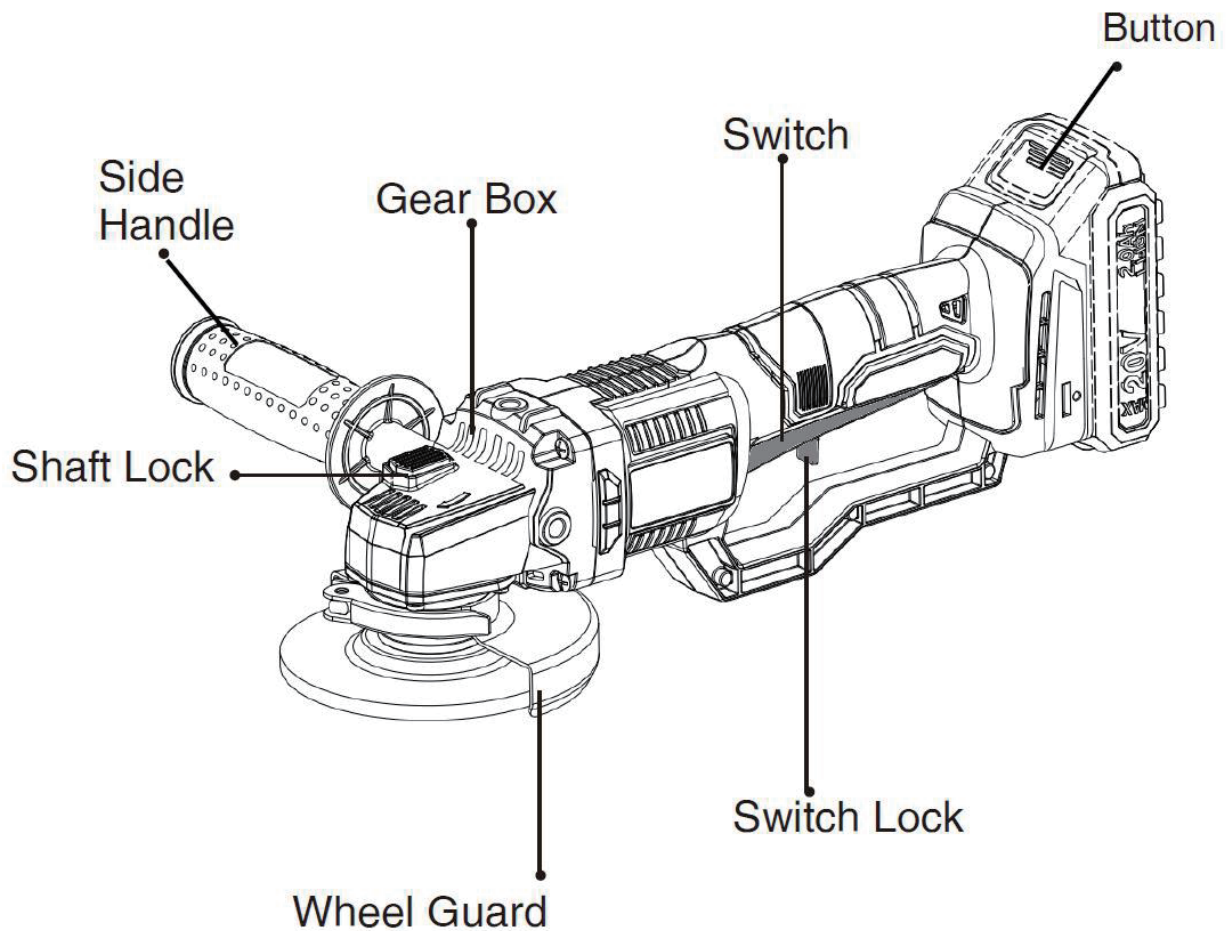

GENERAL POWER TOOL SAFETY RULES

WARNING!

Read and save all safety warnings and instructions carefully. Failure to follow these warnings may result in electric shock, fire, or serious injury. Keep all warnings and instructions for future reference. The term “power tool” in these warnings applies to both mains-operated (corded) and battery-operated (cordless) tools.

WORK AREA SAFETY

- **Keep the work area clean and well-lit.** Cluttered or poorly lit spaces increase the risk of accidents.
- **Avoid operating power tools in explosive atmospheres.** Do not use tools in environments with flammable liquids, gases, or dust, as power tools generate sparks that could ignite these substances.
- **Keep children and bystanders at a safe distance** while operating a power tool. Distractions can lead to a loss of control, increasing the risk of injury.

ELECTRICAL SAFETY

- **Ensure power tool plugs match the outlet.** Never modify the plug in any way or use adapter plugs with earthed (grounded) power tools. Properly matched, unmodified plugs and outlets reduce the risk of electric shock.
- **Avoid contact with earthed or grounded surfaces** such as pipes, radiators, ranges, and refrigerators. Contact with these surfaces increases the risk of electric shock.
- **Keep power tools away from rain or wet conditions.** Water entering a power tool significantly raises the risk of electric shock.
- **If using a power tool in a damp location is unavoidable,** ensure the power supply is protected by a **Ground Fault Circuit Interrupter (GFCI)**. A GFCI reduces the risk of electric shock in such conditions.

PERSONAL SAFETY

- **Stay alert and focused.** Always pay attention to what you are doing and use common sense when operating a power tool. Avoid using power tools if tired or under the influence of drugs, alcohol, or medication. A moment of inattention can result in serious personal injury.
- **Use appropriate personal protective equipment.** Always wear eye protection, and use additional protective equipment such as a dust mask, non-skid safety shoes, a hard hat, or hearing protection, depending on the conditions. These measures reduce the risk of injury.
- **Prevent unintentional starting.** Ensure the switch is in the OFF position before connecting the tool to a power source, attaching a battery pack, picking up, or carrying the tool. Carrying tools with your finger on the switch or connecting power while the tool is on increases the risk of accidental activation.
- **Remove all adjusting keys or wrenches before turning on the tool.** Leaving these attached to rotating parts can cause serious personal injury.
- **Maintain proper footing and balance.** Avoid overreaching, and always keep a stable stance to retain control of the tool in unexpected situations.
- **Dress appropriately.** Avoid wearing loose clothing or jewellery, and ensure long hair is tied back. Keep hair, clothing, and gloves away from moving parts to prevent entanglement.
- **Use dust extraction and collection systems if available.** Properly connecting and using these systems helps reduce dust-related hazards.

POWER TOOL USE AND CARE

- **Use the correct tool for the job.** Do not force the power tool to perform tasks it is not designed for. The appropriate power tool will complete the task more efficiently and safely when used as intended.
- **Ensure proper operation of the switch.** Do not use the power tool if the switch does not properly turn it on and off. A tool that cannot be controlled via the switch is hazardous and should be repaired before use.
- **Disconnect the power source before adjustments.** Always unplug the Tool or remove the battery pack before adjusting, changing accessories, or storing the tool. This precaution prevents accidental activation.
- **Store tools securely and out of reach of children.** Keep idle power tools in a safe location, away from children and individuals unfamiliar with their operation. Tools in the hands of untrained users can be dangerous.
- **Maintain tools.** Regularly inspect power tools for misalignment, binding of moving parts, breakage, or any condition that may affect their performance. Damaged tools should be repaired before use, as poorly maintained tools are a common cause of accidents.
- **Keep cutting tools sharp and clean.** Properly maintained and sharp cutting edges reduce the likelihood of binding and make the tool easier to control.
- **Follow the tool's instructions and intended use.** Use the power tool, accessories, and bits according to the provided instructions and the conditions of the task. Using tools for unintended applications can lead to hazardous situations.

BATTERY TOOL USE AND CARE

- **Recharge only with the charger specified by the manufacturer.** Using a charger designed for a different battery pack may pose a risk of fire or damage to the battery.
- **Use designated battery packs.** Operate power tools only with the specific battery packs recommended by the manufacturer. Using other battery packs may result in injury or fire.
- **Store battery packs safely.** When not in use, keep the battery pack away from metal objects such as paper clips, coins, keys, nails, or screws. These items can create a connection between terminals, potentially causing burns or a fire.
- **Handle leaking batteries with care.** Under abusive conditions, liquid may leak from the battery:
 - Avoid contact with the liquid.**
 - If accidental contact occurs, flush the area with water.
 - If the liquid enters the eyes, rinse thoroughly with clean water for at least 10 minutes and seek medical attention.
 - Battery liquid may cause irritation or burns.

SERVICE

- **Use qualified service professionals.** Always have power tools serviced by a qualified repair technician at Adendorff Machinery Mart www.adendorff.co.za, ensuring that only identical replacement parts are used. This guarantees the safety and performance of the tool.
- **Adhere to maintenance guidelines.** Follow the manufacturer's instructions for lubrication and accessory changes to maintain the tool's functionality and longevity.
- **Maintain cleanliness.** Keep handles and external surfaces dry, clean, and free from oil and grease. A clean tool provides better grip and reduces the risk of slipping during use.

SAVE THESE INSTRUCTIONS

These safety instructions will help ensure safe and effective operation of the tool.

WARNING

- **DO NOT** let comfort or familiarity with the product (gained from repeated use) replace strict adherence to safety rules for the subject product. MISUSE or failure to follow the safety rules stated in this instruction manual may cause serious personal injury.
- It's essential to remain vigilant and prioritize safety every time the tool is used, regardless of the level of experience. Always follow the instructions and safety guidelines to avoid accidents and injuries.

GRINDING TOOL SAFETY

- **Always use the appropriate guard:** Ensure a proper guard is attached when using the grinding wheel. The guard protects the operator from broken wheel fragments.
- **Check accessory ratings:** Use accessories rated for at least the speed indicated on the tool's warning label. Operating wheels or accessories beyond their rated speed can cause them to disintegrate, leading to injury.
- **Insulated gripping surfaces:** Hold the tool by its insulated surfaces when grinding operations might contact hidden wiring or the tool's cord. Contact with a "live" wire can electrify exposed metal parts, leading to a risk of electric shock for the operator.
- **Use reinforced grinding wheels:** When using depressed center grinding wheels, use only fiberglass-reinforced wheels designed for this purpose.
- **Wear safety glasses:** Always use safety glasses or goggles; regular eyeglasses or sunglasses are not sufficient protection.
- **Inspect the wheel:** Before use, check the wheel for cracks or damage. Replace any cracked or damaged wheels immediately. Test the tool (with the guard installed) at no load for one minute, holding it away from others. A flawed wheel is likely to fail during this test.
- **Use specified flanges:** Only use the flanges specified for this tool.
- **Avoid damaging components:** Take care not to damage the spindle, flange. (especially the mounting surface), or lock nut. Damage to these parts can cause the wheel to break.
- **Do not use improper blades:** Never use wood-cutting or other saw blades with a grinder. These blades often kick back, causing loss of control and potential injury.
- **Keep hands away from rotating parts:** Avoid contact with moving components during operation.
- **Start safely:** Ensure the wheel is not in contact with the workpiece before turning the tool on.
- **Run a test spin:** Let the tool run without a load before starting work to detect vibration or wobbling that may indicate improper installation or an unbalanced wheel.
- **Use the correct grinding surface:** Grind using only the specified surface of the wheel.
- **Watch for sparks:** Position the tool to direct flying sparks away from yourself, others, and flammable materials.
- **Operate hand-held only:** Do not leave the tool running unattended. Always operate the tool while hand-held.
- **Avoid burns:** Do not touch the workpiece immediately after operation, as it may be extremely hot and can cause burns.
- **Wear appropriate protective clothing:** Always wear long-sleeved shirts, leather gloves, and shop aprons to protect skin from contact with hot grindings.
- **Beware of hazardous dust:** Grinding or sanding certain materials, such as paints, woods, or other products, may expose to harmful substances. Always use appropriate respiratory protection to reduce exposure to hazardous dust.

IMPORTANT SAFETY INSTRUCTIONS FOR BATTERY CARTRIDGE

- **Read all instructions and cautionary markings.** Before using the battery cartridge, carefully review the instructions and safety warnings provided for the:

Battery charger	Battery	Product using the battery
-----------------	---------	---------------------------
- **Do not disassemble the battery cartridge.** Disassembly can result in safety hazards or damage.
- **Discontinue use if operating time shortens significantly.** If the battery's operating time becomes excessively shorter, stop using it immediately. Continued operation may lead to overheating, burns, or even an explosion.
- **Handle electrolyte exposure with care.** If electrolyte comes into contact with your eyes:
 - Rinse them thoroughly with clear water for at least 10 minutes.
 - Seek medical attention immediately. Electrolyte can cause severe irritation or potential loss of eyesight.

DO NOT SHORT THE BATTERY CARTRIDGE

- **Avoid contact with terminals.** Do not touch the terminals of the battery cartridge with any conductive material.
- **Store the battery safely.** Do not store the battery cartridge in containers with other metal objects, such as nails, coins, or screws, to prevent accidental short circuits.
- **Protect from moisture.** Keep the battery cartridge away from water or rain. A short circuit caused by exposure to moisture can result in a large current flow, overheating, burns, or even battery failure.
- **Store in proper conditions.** Do not store the tool or battery cartridge in locations where the temperature may exceed 50°C (122°F).
- **Do not incinerate.** Never burn the battery cartridge, even if it is severely damaged or completely worn out. Incineration can cause the battery to explode.
- **Handle with care.** Avoid dropping or striking the battery cartridge to prevent internal damage.
- **Inspect before use.** Do not use a damaged battery cartridge under any circumstances.

TIPS FOR MAINTAINING MAXIMUM BATTERY LIFE

- **Charge before complete discharge.** Stop using the tool and recharge the battery cartridge as soon as reduced power is noticed. Avoid fully depleting the battery to prolong its lifespan.
- **Do not overcharge.** Avoid recharging a fully charged battery cartridge. Overcharging can reduce the battery's service life.
- **Charge within the recommended temperature range.** Ensure the battery cartridge is charged in an environment with a temperature between 10°C - 40°C (50°F - 104°F). Allow the battery cartridge to cool down if it is hot before recharging.

IMPORTANT CHARGING NOTES

- **Do not store in locations where the temperature may exceed 40°C:** Ensure that the tool is stored in a cool, dry place.
- **Charge only at ambient temperatures between 4°C and 40°C:** Charging outside this range can cause damage to the battery.
- **Charge only using the charger provided with the tool:** Other chargers may use different amperages that can damage or destroy the battery and/or tool.
- **Unplug charger before attempting to clean:** Always unplug the charger before cleaning to prevent electric shock or damage to the charger.
- **Do not immerse the charger in water or any other liquid:** Avoid getting the charger wet to prevent electric shock or damage.

FUNCTIONAL DESCRIPTION

CAUTION!

- **Ensure safety before adjustments:** Always make sure the tool is switched off and unplugged (or the battery is removed) before adjusting or checking any functions on the tool.

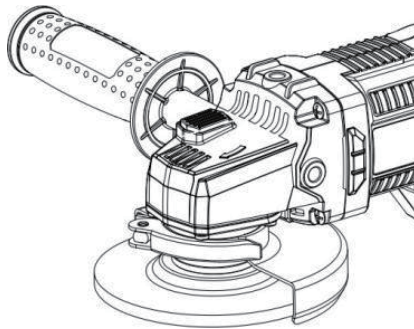

ASSEMBLY

CAUTION!

- **Avoid using the shaft lock on a moving spindle:** Never press the shaft lock while the spindle is in motion, as this may damage the tool.
- **Use the shaft lock during accessory changes:** Press the shaft lock to prevent spindle rotation when installing or removing accessories.

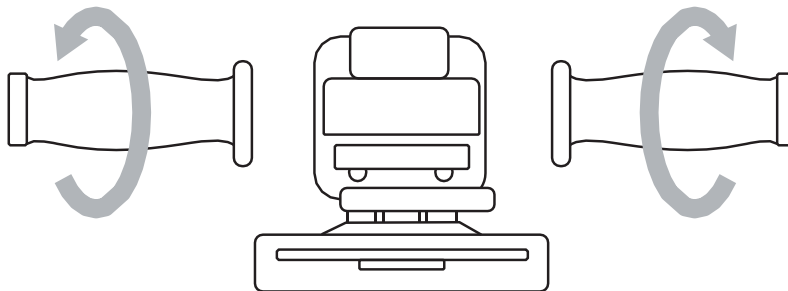

CAUTION!

- **Ensure power is off before maintenance:** Always confirm that the tool is switched off and unplugged (or the battery is removed) before performing any work or maintenance on the tool.

INSTALLING SIDE GRIP (HANDLE)

CAUTION!

- **Ensure the side grip is secure:** Always confirm that the side grip is securely installed before beginning operation.
- **Proper installation:** Screw the side grip firmly into the designated position on the tool, as illustrated in the user manual.

INSTALLING OR REMOVING WHEEL GUARD

CAUTION!

- **Use the wheel guard appropriately:** When using a depressed center grinding wheel, multi-disc, flex wheel, wire wheel brush, cut-off wheel, or diamond wheel, ensure the wheel guard is installed. The closed side of the guard must always face toward the operator.
- **Proper mounting procedure:** Align the protrusion on the wheel guard band with the notch on the bearing box. Then rotate the wheel guard approximately 180°. Ensure the screw is tightened securely to hold the guard in place.
- **Removing the wheel guard:** To remove the wheel guard, reverse the installation procedure. Screw the lock nut onto the spindle. To tighten the lock nut, press the shaft lock firmly to prevent the spindle from revolving, then use the lock nut wrench to securely tighten it clockwise.

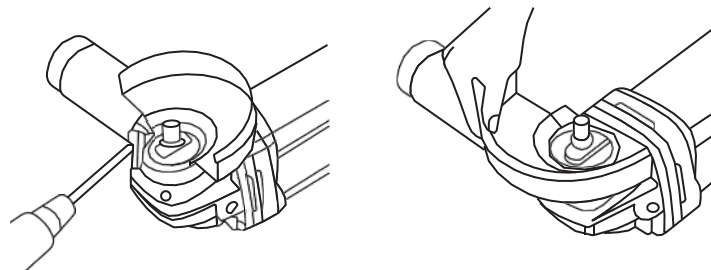

INSTALLING OR REMOVING DEPRESSED CENTER GRINDING WHEEL / MULTI DISC

WARNING!

- **Always use the supplied guard:** When using a depressed center grinding wheel or multi-disc, ensure the supplied guard is installed. The wheel can shatter during use, and the guard reduces the risk of personal injury.
- **MOUNTING THE WHEEL/DISC:**
 - 1.) Mount the inner flange onto the spindle.
 - 2.) Fit the wheel/disc onto the inner flange.
 - 3.) Screw the lock nut onto the spindle. To tighten the lock nut, press the shaft lock firmly to prevent the spindle from revolving, then use the lock nut wrench to securely tighten it clockwise.
- **REMOVING THE WHEEL/DISC:**
Follow the installation procedure in reverse to remove the wheel or disc.

COMPONENTS:

- 1.) Lock Nut
- 2.) Depressed Centre Grinding Wheel/Multi-Disc
- 3.) Inner Flange

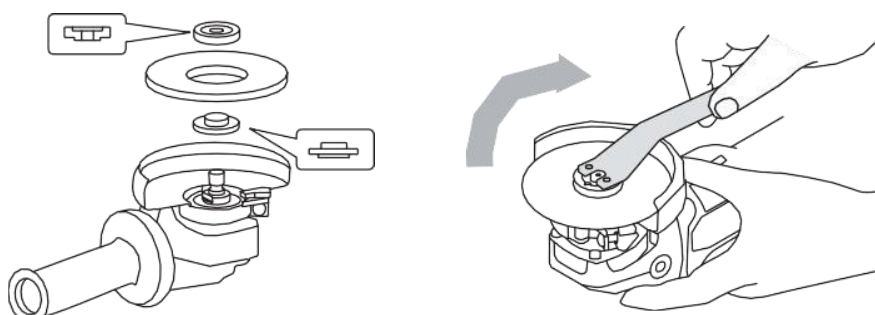

WARNING!

- **Do not force the tool:** The tool's weight provides sufficient pressure for effective operation. Forcing the tool or applying excessive pressure can lead to dangerous wheel breakage.
- **Replace the wheel after impact:** Always replace the grinding wheel if the tool is dropped while in use to avoid potential damage or failure during operation.
- **Avoid striking the wheel:** Never bang or hit the grinding disc or wheel against the workpiece.
- **Prevent bouncing and snagging:** Take extra care to avoid bouncing or snagging the wheel, especially when working on corners, sharp edges, or irregular surfaces. Such actions can cause a loss of control or kickback.

CAUTION!

- **Switch off after operation:** After using the tool, always turn it off and wait for the wheel to come to a complete stop before setting the tool down.
- **Adjustable speed control:** The dimmer can be adjusted to six variable levels. By using the speed controller, grinding and sanding operations can be performed effectively and efficiently.

DIMMER (VARIABLE SPEED CONTROL)

- **Variable speed control:** The dimmer can be adjusted across six levels. By modifying the speed controller, grinding and sanding operations can be optimized for precise and efficient performance.

GRINDING AND CUTTING OPERATION

- **Proper handling and operation:** Always hold the tool firmly, with one hand on the housing and the other on the side handle. Turn the tool on before applying the wheel or disc to the workpiece.
- **Maintain correct angle:** Generally, keep the edge of the wheel or disc at an angle of approximately 15 degrees to the surface of the workpiece.
- **Break-in period for new wheels:** During the initial break-in period with a new wheel, avoid working the grinder in the "B" direction, as this may cause it to cut into the workpiece. Once the edge of the wheel has been rounded off through use, the wheel can be safely worked in both "A" and "B" directions.

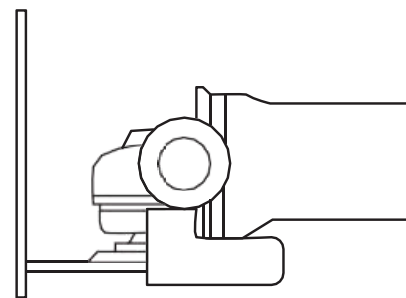
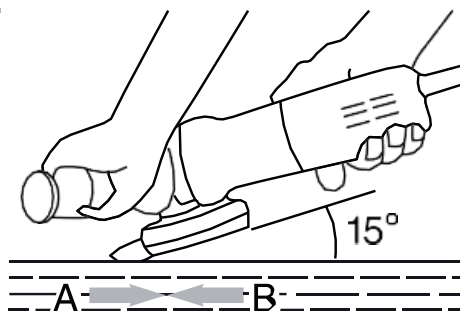

- **Sparks during metal cutting:** Cutting metal materials produces sparks. Ensure the surrounding area is clear of flammable materials before starting work.
- **Apply controlled pressure:** Maintain steady pressure on the workpiece surface. Excessive force can decrease the disc's speed and affect performance.
- **Disc positioning:** Ensure the disc is perpendicular to the workpiece for precise cutting. Move the grinder against the clockwise rotation of the disc for improved accuracy.
- **Proper disc selection:** Use the appropriate disc for cutting concrete materials.
- **Use the disc edge for cutting:** Always apply the edge of the disc for cutting tasks. Using the flat plate of the disc instead of its edge can cause disc breakage and result in serious damage or injury.

INSTALLING OR REMOVING BATTERY CARTRIDGE

- **To remove the battery cartridge:** Slide the red button on the front of the cartridge and carefully withdraw it from the tool.
- **To insert the battery cartridge:** Align the tongue of the battery cartridge with the groove in the tool's housing. Slide the cartridge into place, ensuring it is inserted all the way until it locks in with a distinct click.
- **Avoid using force:** If the battery cartridge does not slide in easily, it is not aligned correctly. Check the alignment and try again.

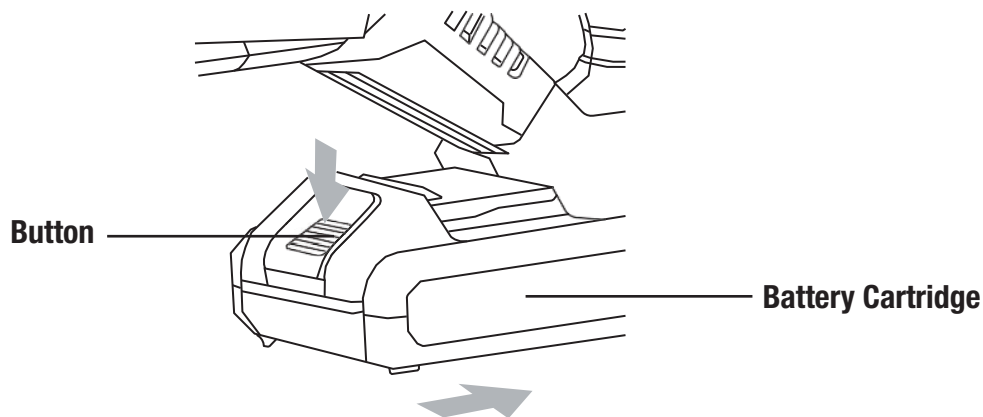

BATTERY CHARGER OPERATION

Power off before connecting. Ensure the power source switch is turned **OFF** before plugging in the battery charger.

Review the instruction manual. Familiarize yourself with the entire manual before beginning any operation.

Insert the battery correctly. Align the terminals on the battery with those on the charger and slide the battery into place. It will lock securely with an audible click!

Plug in the battery charger then turn **ON** the power source

The charge state lights will indicate the following:

SOLID RED = Charging

SOLID GREEN = Fully Charged

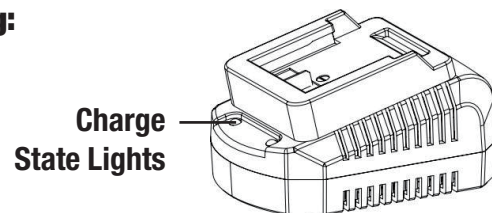

NOTE:

To remove the battery: Press the **Battery Release Button** while gently pulling the battery away from the charger.

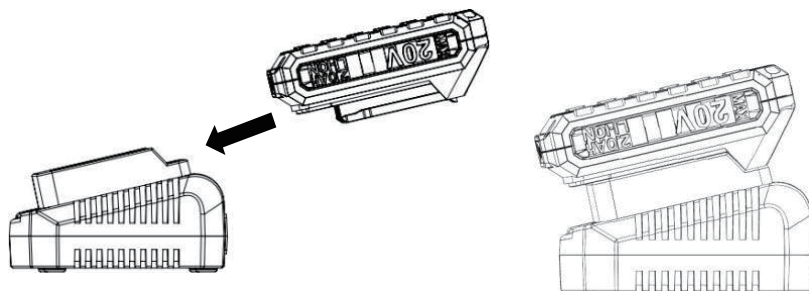

GENERAL INSPECTION

- **BEFORE EACH USE:**
Inspect the general condition of the tool thoroughly. Check for:
 - Leaking, swollen, or cracked battery pack.
 - Loose hardware.
 - Misalignment or binding of moving parts.
 - Cracked or broken parts.
 - Any other condition that may compromise safe operation.

MAINTENANCE

CAUTION:

- **Ensure safety before maintenance:** Always switch off the tool and remove the battery cartridge before performing any inspection or maintenance.
- **Avoid harmful substances:** Do not use petrol, diesel, benzene, thinner, alcohol, or similar substances for cleaning. These chemicals can cause discoloration, deformation, or cracks in the tool's materials.

NOTE:

- **Authorized repairs only:** To ensure product safety and reliability, all repairs, maintenance, or adjustments should be performed exclusively by Adendorff Machinery Mart Authorized Service Centers.
- **Use genuine parts:** Always use Adendorff Machinery Mart-approved replacement parts to maintain the tool's performance and warranty coverage.

STORAGE

- **Keep the tool stored in a dry, level area,** away from dampness, moisture, and rainfall.
- **Allow the tool to cool down completely before storing.**
- **Ensure the tool is clean and dry before storage.**
- **Store the tool in a position where it cannot be accidentally stepped on or moved,** especially to reach higher items.

DO NOT:

- **Do not store the tool near an ignition source,** such as a wood stove, gas or electric heater, or any appliance with a pilot light.
- **Do not stack heavy or other items on top of the tool during storage.**

IMPORTANT:

- **Store the tool out of reach of children or individuals unfamiliar with its operation.**
- **Avoid direct sunlight or extreme temperatures. Store the tool indoors or in a safe, frost-free area**

PARTS LIST IGRINC-001

No.	Description
1	Cross-Head Tapping Screw
2	Lock Button
3	Spring
4	Check Ring
5	Alu Housing
6	Needle Bearing Hk0810
7	Ring
8	Big Gear
9	Cross-Head Tapping Screw
10	Deep Groove Ball Bearing 6000
11	Woodruff Key
12	Output Shaft
13	Bearing Seat
14	Cross Disc Head Tooth Screw
15	Fast Change Protect Cover
16	Down Flange
17	Disc(Not Including)
18	Upper Flange
19	Self-Locking Nut
20	Small Gear
21	Bearing Ring
22	Bearing 609
23	Bearing Pressure Plate
24	Cross Groove Head With Cushion Screws
25	Woodruff Key
26	Brushless Motor
27	Controller
28	Foot-Hold
29	Microswitch
30	Trigger Spring
31	Knob Pin
32	Trigger Reset Torsion Spring
33	Switch Button
34	Switch Trigger
35	Left+Right Housing
36	Cross-Head Tapping Screw
37	Wrench
38	Charger 21.5 (Sold Separately)
39	Battery (Sold Separately)
40	Side Handle

WARRANTY TERMS & CONDITIONS

WARRANTY PERIOD

- This product is warranted for 12 months from the date of purchase by the first user.

COVERAGE

- The warranty covers all material or production flaws, with exceptions:
 - Batteries and chargers
- Parts subject to normal wear (e.g., bearings, brushes, cables, plugs)
- Accessories (e.g., drill bits, saw blades)

EXCLUSIONS

The warranty does not cover damage or defects from:

- Maltreatment, accidents, or alterations
- Inappropriate or negligent use of the tool
- Overloading, fluid permeation, excessive dust, or intentional damage
- Non-compliance with manual instructions, inexperienced assembly, lightning, or incorrect voltage

LIABILITY

- Adendorff Machinery Mart disclaims liability for bodily injury resulting from improper tool use.

REPAIRS

- All Warranty repairs must be conducted by an authorized Adendorff Machinery Mart repair center. All stores have in-house service technicians.

TRANSPORTATION COSTS

- Transportation costs for service are the customer's responsibility unless otherwise agreed in writing.

WARRANTY CLAIMS

- All Warranty claims do not extend or restart the warranty period.
- Claims may be rejected if purchase cannot be verified or if product maintenance is found to be lacking.
- A 3-month (Three Months) warranty applies to any repairs performed.

MAINTENANCE AND PROOF OF PURCHASE

- Maintain the product as instructed (e.g., clean ventilation slots, service carbon brushes regularly).
- Retain the purchase receipt as proof of purchase date.

RETURN CONDITIONS

- Return the product intact, in clean condition, and in its original blow-molded case (if applicable), along with proof of purchase.

For full warranty details, visit www.adendorff.co.za. For assistance, contact the national call centre at 011 434 7000.

 **Kinway**

Supplied By

Adendorff
machinery mart